

Duro-M - 4-Backen, Inside and outside jaws, Short taper mount, mounting from front (ISO 702-1/DIN 55026)

APPLICATION

Conventional clamping horizontal and vertical turning machines, as well as milling machines, rotary tables and dividing attachments. Predominantly for use in single or small batch production or in repair shops.
Clamping of rotationally symmetrical parts for turning and milling

TYPE

The Duro-A is a manually geared scroll chuck with through hole, that can be clamped automatically (hydraulically) by a CNC machine. It is mainly used for turning cylindrical and disc-shaped blanks.

CUSTOMER BENEFITS

- High concentricity up to 0.02
- Jaws with gunmetal finish
- Minimal interference contour
- Optimum force transmission
- Drip edge for coolant

TECHNICAL FEATURES

- Chuck body (and all other components) made of steel
- ENG Zentrisch spannend über Planspirale
- ENG Planspirale im Gesenk geschmiedet und hochvergütet, Gewindeflanken beidseitig geschliffen
- Jaws in chuck ground out for concentricity
- Zero drive determined in the factory as precision drive
- The maximum permissible speed has been fixed so that 1/3 of the gripping force is still available as residual gripping force if the maximum gripping is applied and the chuck is fitted with its heaviest jaws. The jaws may not project beyond the outside diameter of the chuck. The chuck must be in perfect condition. The specification DIN 6386 Part 1 shall be observed.
- Clamping force to DIN 6350: The gripping force is the sum total of all jaw forces acting radially on the stationary workpiece. The specified gripping forces are approximate values. They apply to chucks in a perfect condition which have been lubricated with RöhM F80 grease.
- Scope of supply: chuck, operating key, jaws

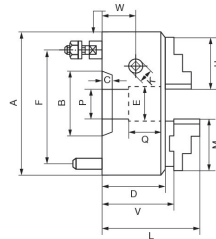

A09 820

Size	160	200	200	250	250	250	315	315			400	400	500	630	630
Kurzkegel	5	5	6	5	6	8	6	8			8	11	11	11	15
A [mm] Außendurchmesser	160	200	200	250	250	250	315	315			400	400	500	630	630
B Aufnahme	82,5	82,5	106,4	82,5	106,4	139,7	106,4	139,7			139,7	196,9	196,9	196,9	285,9
D [mm] - Futterhöhe	66	74,5	74,5	83	83	83	96	96			106	106	122	137	137
E [mm] Durchgang (max)	42	42	55	76	55	76	103	76			136	125	190	190	190
F [mm]	61,9	61,9	82,6	104,8	82,6	111,1	133,4	111,1			171,4	165,1	235	235	247,6
H [mm] Länge Bohr- und Drehbacke	61	69	69	90	90	90	130	130			130	130	190	190	190
J [mm] Höhe Backe	26	32,5	32,5	40	40	40	46	46			43	43	54,5	54,5	54,5
K [mm] Größe Futterschlüssel	10	11	11	12	12	12	14	14			17	17	19	19	19
Betätigung (Drehmomentschlüssel) [Nm]	110	140	140	150	150	150	180	180			240	240	260	280	280
Spannkraft [kN] max, gesamt	47	55	55	63	63	63	69	69			92	92	100	105	105
Drehzahl [min-1], max. zul.	4600	4000	4000	3000	3000	3000	2300	2300			1800	1800	1300	850	850
Item no.	185402 ▲	185403 ▲	185404 ▲	185405 ▲	185406 ▲	185407 ▲	185408 ▲	185409 ▲	185410	185411	185412 ▲	185413 ▲	185414 ▲	185415 ▲	185416 ▲